

Facility Rentals

the reach
GALLERY MUSEUM



PICTURE YOUR NEXT EVENT AT
THE REACH GALLERY MUSEUM
ABBOTSFORD!

Our unique facility hosts two seasons of exhibitions annually and is home to an additional award winning museum exhibition. With three distinct areas available to rent, The Reach is the perfect place to hold your next workshop, reception, speaking engagement, or fundraising event.



Room and Fee Information

Event Area & Lobby *



The Event Area & Lobby is the ideal place to host your next fundraiser or corporate reception. This inviting space can host up to 75 guests at seated events (lecture or reception-style) or elegant standing receptions with up to 150 guests. You guests will enjoy a true gallery experience surrounded by stunning art exhibitions. You will also have the option to add in an LCD Projector with screen, great in-house sound system, and baby-grand piano to elevate your event.

Capacity: 75-150

\$150/hr

minimum 4 hour rental

Lobby *



Planning a small reception or gathering? Our Lobby space is the perfect place to host a small social gathering, an info session with table displays, or a meet & greet. This airy and welcoming space can accommodate up to 50 people in a standing reception, or 20 seated guests (lecture-style). As part of your rental of this space, your guests will meet Xataluk (our welcome figure), enjoy works of art by emerging artists in our Atrium Gallery and get an intimate look at the exhibitions in our Grotto Gallery.

Capacity: 20-50

\$90/hr

minimum 4 hour rental

Studio



The Studio is an excellent place to host your next AGM, board meeting, info session or workshop. This large, multi-purpose space can be configured as a meeting room, classroom or workspace. The space can accommodate approximately 30 seated guests (lecture style) and approximately 50 guests for a standing reception. Throughout most of the year your guests can enjoy displays of artwork created by our community. We also welcome your guests to explore the fascinating history of Abbotsford in our award winning museum exhibition adjacent to the Studio. A portable PA system, LCD projector and other equipment are available to be added on to accommodate your needs.

Capacity: 30-50

\$75/hr

Event: min. 4 hr rental
Meeting: min. 2 hr rental

* These rental areas are available outside of business hours only.

Birthday Parties

Make your child's birthday party an unforgettable experience!

Our unique children's art parties, allow each child to explore their creative side while making lasting memories with their friends and family! The art activity will be led by an experienced Reach facilitator with content tailored by age group. After this fun hands-on art project the room is yours for food, cake and presents. A perfect way to make any occasion special and one-of-a-kind!

Capacity: 20 (Minimum 2 adults required)

\$300

2 hour rental

Equipment and Linens

Item	Description	Price
Speaker Package (Event Space)	Microphone, podium, house sound	\$100.00/pkg
Speaker Package (Studio)	Microphone, podium, house sound	\$50.00/pkg
Presenter Package (Event Space)	Microphone, podium, house sound, projector and screen. Optional items: sound board, stand speakers & laptop. <small>**Depending on requirements, may require AV Technician support for additional fee</small>	\$200.00/pkg
Presenter Package (Studio)	Microphone, podium, house sound, projector and screen. Optional items: sound board, stand speakers & laptop. <small>**Depending on requirements, may require AV Technician support for additional fee</small>	\$100.00/pkg
Tables	Large Round (5ft)	\$8.50/ea
	Rectangle (6ft)	\$8.50/ea
	Cocktail/High top	\$7.50/ea
Chairs	Folding or Stacking (black)	\$1.20/ea
Tablecloths	For Round, Rectangle, or Cocktail Tables	\$7.00/ea
Baby Grand Piano***		\$250.00/ea
Stanchions		\$2.00/ea
Event Support Staff	Reach staff required to support event	\$25.00/hr
**AV Technician	AV Technician required for complex presentations (e.g. use of sound board)	\$30.00/hr

***Rentals requiring the Baby Grand Piano must be booked a minimum of 30 days in advance to ensure piano is properly tuned. Piano rental does not include Pianist.

Floor Plan

☐ Shaded gray denotes the Rental Areas
(Rental Areas subject to change)

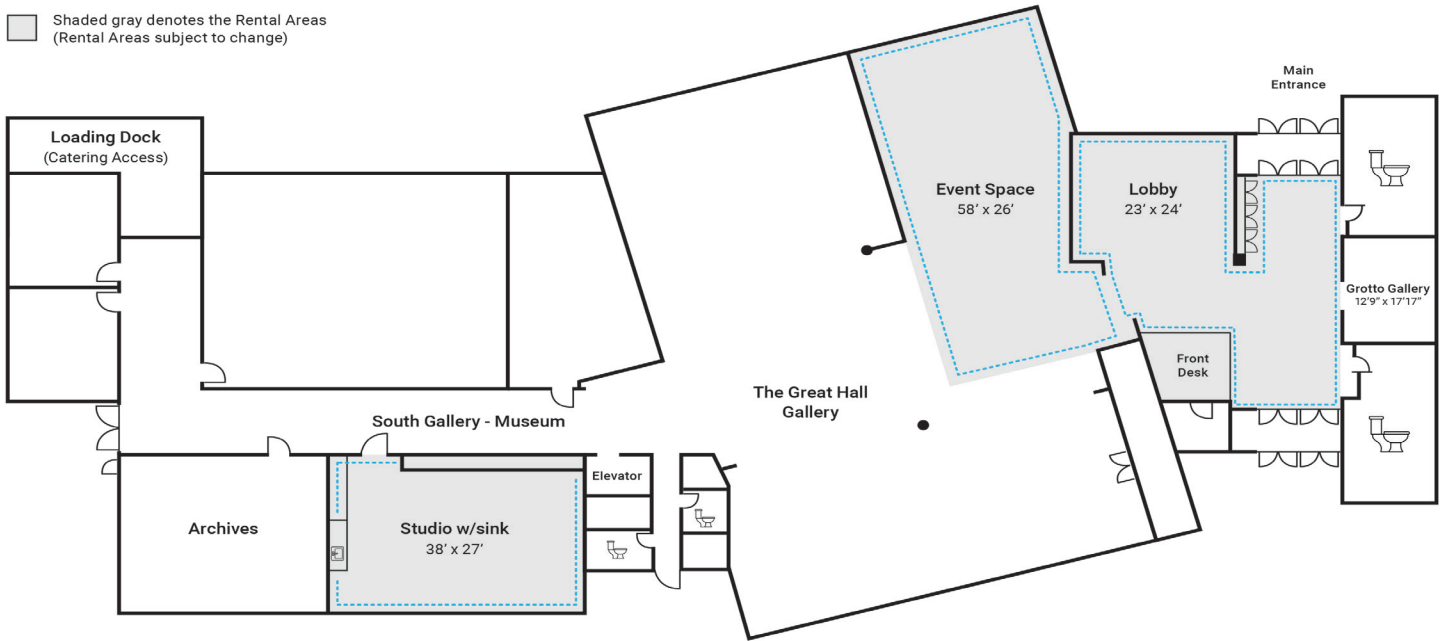

The Fine Print

- These costs are for the use rental of space alone for a minimum four rental. Additional charges apply for equipment use and after-hours staffing cost.
- Rental groups are required to obtain liability insurance, liquor liability insurance, and liquor permit (if applicable).
- All renters are responsible for arranging their own catering, and crew for setup and cleanup. Cooking is not permitted on premise.
- \$250 deposit and a signed agreement are required to reserve your rental.

For more information or to plan your event, please contact:

Stochia Ocon
Programs and Events Coordinator
Phone: (604) 864-8087, ext. 116 | Email: socon@hereach.ca

the reach
GALLERY MUSEUM

32388 Veterans Way | Abbotsford, BC | V2T 0B3
www.thereach.ca

The Reach is located on Stó:lō Téméxw, in the unceded Stó:lō territory of the Semá:th and Mathxwí First Nations.